

SAE Size	IDEAL Part Number	TRIDON Part Number	"A" Dia.	
			Min.-Max.	Min.-Max.
			inch	mm
08	6708M	6708M	.63 - 1.00	16 - 25
10	6710M	6710M	.68 - 1.13	17 - 29
12	6712M	6712M	.69 - 1.25	17 - 32
16	6716M	6716M	.77 - 1.50	20 - 38
20	6720M	6720M	1.06 - 1.75	27 - 44
24	6724M	6724M	1.08 - 2.00	27 - 51
28	6728M	6728M	1.30 - 2.25	33 - 57
32	6732M	6732M	1.55 - 2.50	39 - 64
36	6736M	6736M	1.80 - 2.75	46 - 70
40	6740M	6740M	2.05 - 3.00	52 - 76
44	6744M	6744M	2.30 - 3.25	58 - 83
48	6748M	6748M	2.55 - 3.50	65 - 90
52	6752M	6752M	2.80 - 3.75	71 - 95
56	6756M	6756M	3.05 - 4.00	78 - 102
60	6760M	6760M	3.30 - 4.25	84 - 108
64	6764M	6764M	3.55 - 4.50	90 - 114
72	6772M	6772M	4.05 - 5.00	103 - 127
88	6788M	6788M	5.05 - 6.00	128 - 152
96	6796M	6796M	5.55 - 6.50	141 - 165
128	6795M	6795M	7.55 - 8.50	192 - 215

○
ALL 316 SS
IDEAL-TRIDON
HOUSING MARKING [N]
VIEW A-A

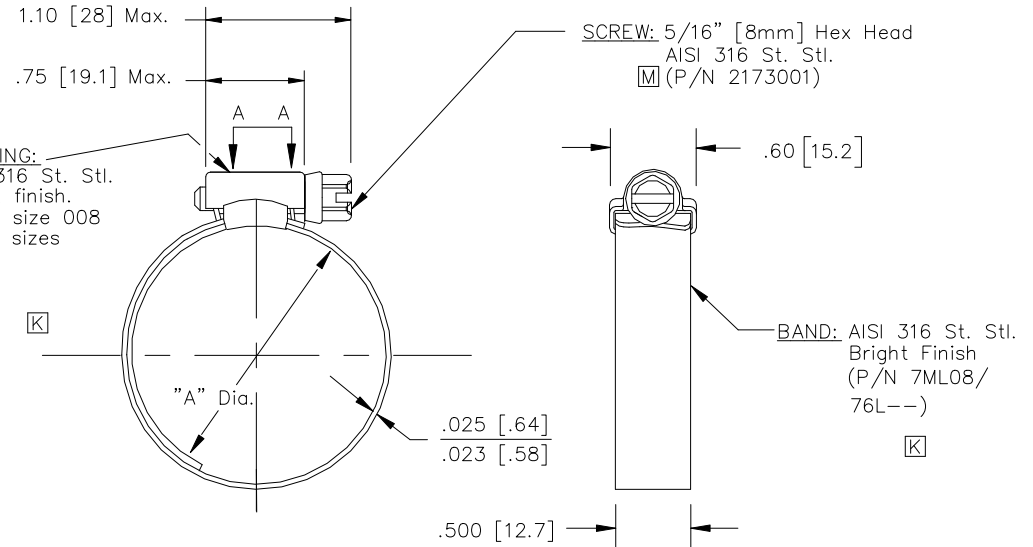

[J] 2813002 for size 008
[P] 2157003 for sizes 010 & up

Notes:

1) Maximum Out of Round condition is not to exceed 5% for sizes 40 & under.

Construction:

Housing to be one piece, mechanically locked to band.

Torque Requirement:

When mounted on a round steel arbor of "A" dia. max., less .062" (1.57mm), clamp must be capable of withstanding 60.0 in.-lbs. Min. (6.9 Nm) of torque applied by a hand torque wrench.

[R] Free Torque:

1.0-4.0 in.-lbs. (.11 - .46 Nm)

Suggested Installation Torque:

35.0 in.-lbs. (4.0 Nm) for most applications.

REV	DESCRIPTION	ECN	DATE	BY
R	FREE TORQUE WAS 3 LBS MAX	20922	08DEC15	CJC
P	CHG LG HSG FROM 70336 TO 2157003	17528	28JUN11	WC
O	CHG SM HSG FROM 70339 TO 2813002	17528	28JUN11	WC
N	UPDATED HOUSING MARKING TO DUAL BRAND	17203	12FEB11	JBN
M	2173001 SCREW WAS P/N 7W323	16451	2MAR10	JBN
L	Add Tridon P/Ns. Remove Checked Symbol & Note.	6912C	14Jan09	WC
K	Change to Hybrid design.	5627C	26JUN02	WC
J	Establish 6795M, NPA#877. Change Dwg No from 67M00 to 6700M.	4804C	04Dec98	WC
I	CHANGE FREE TORQUE FROM 4.0 TO 3.0 in.-lbs.	4411C	04SEP97	WC



TOLERANCES (IF NOT SPECIFIED)				SCALE	TITLE
X.X ±0.06	X.XXX ±0.005	FRACTION ±1/64			Ideal All 316 St Stl 1/2" 1-Pc Lined Clamp
X.XX ±0.015	X.XXXX ±	ANGLES ±1°			
DWN	MC	04/24/92	MATL	AS NOTED	DWG NO 6700M
CHK	BB	10/06/95	TREAT	AS NOTED	
APP	TP	04/28/92	FINISH	AS NOTED	
					ISSUE R

CONFIDENTIAL
THIS DOCUMENT CONTAINS CONFIDENTIAL INFORMATION BELONGING TO IDEAL ITS CONTENTS ARE NOT TO BE USED OR DISCLOSED TO OTHERS FOR ANY PURPOSE WITHOUT THE EXPRESS CONSENT OF IDEAL.